

FUNCIONAMENTO DA TRAVA

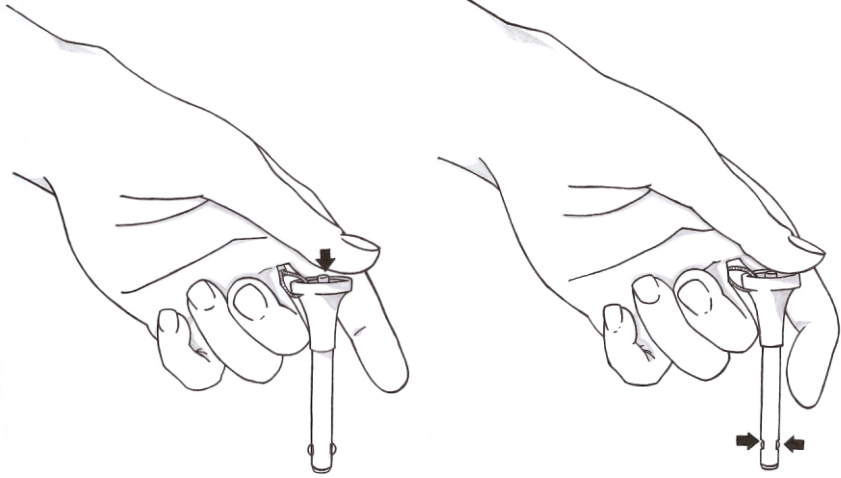

COMO UTILIZAR

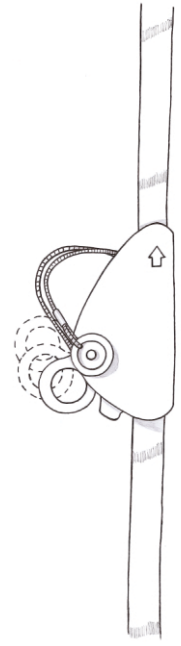
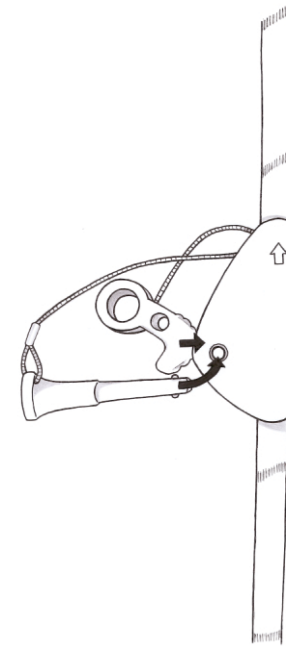
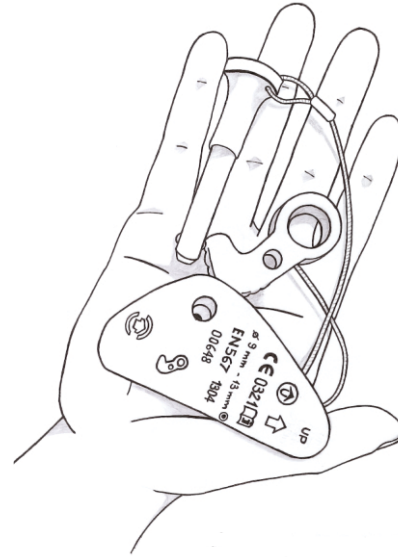

SISTEMA 3X1

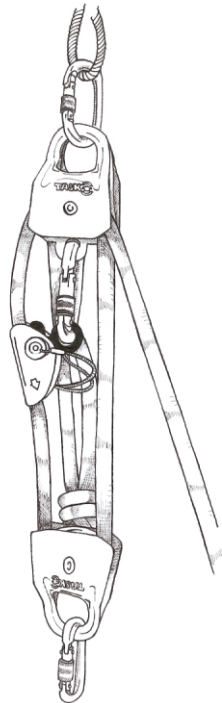

SISTEMA 4X1

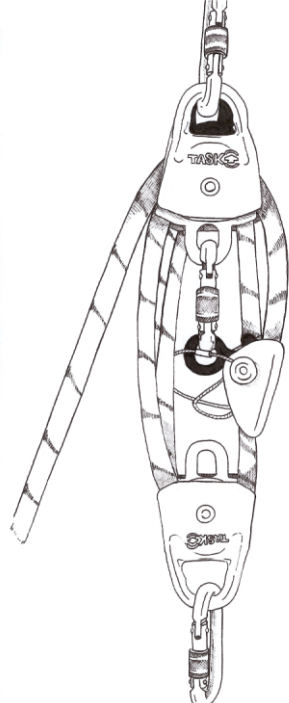

SISTEMA DE REDUÇÃO DE FORÇA MONTADO NO TRIPÉ

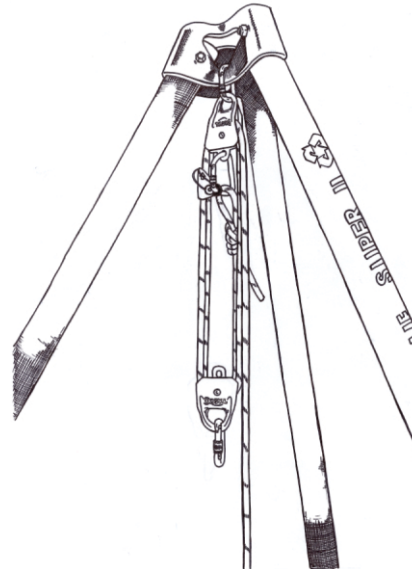

SISTEMA COM RECUPERAÇÃO DE CORDA

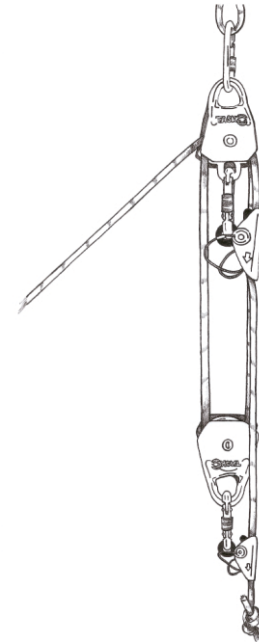

SIGNIFICADO DAS MARCAÇÕES

